



Grade 80 Clevis Clutch Locking Type

Product Specification Sheet

Manufactured to BS EN 1677-1+2

Deutsch BG-Prufzert Type
Approval for Grade 80 Lifting Chain
Components with H91 Certified

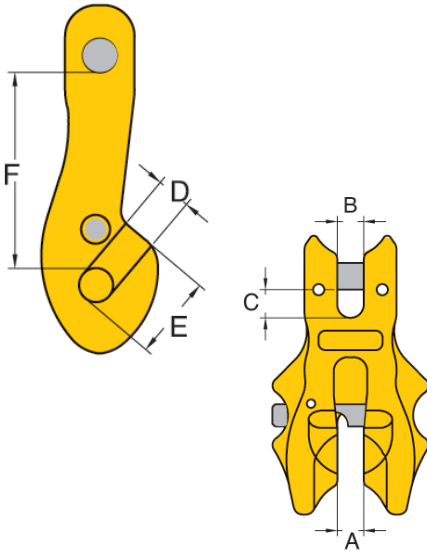

DIMENSIONAL SPECIFICATIONS

Part Code	Chain Size mm	Dimensions mm					
		A	B	C	D	E	F
8-061-07	7,8	10	10	10	10	24	56
8-061-10	10	12	12	12	12	28	66
8-061-13	13	15	15	16	16	39	88

TECHNICAL SPECIFICATIONS

Part Code	Chain Size mm	W.L.L. tonnes	Proof Load kN	M.B.L. kN	Mass Kg
8-061-07	7,8	2.0	49.0	78.4	0.5
8-061-10	10	3.15	77.2	123.0	0.9
8-061-13	13	5.3	130.0	208.0	2.2



Customers purchasing GRADE 80 CLEVIS CLUTCH LOCKING TYPE may also require:

LOAD PIN KITS



Part Code	Chain Size (mm)
8-P026-07	7
8-P026-10	10
8-P026-13	13

Ivy Farm Workshops • High Street • Coddensham • Ipswich • Suffolk IP6 9QX

Tel: 01449 761705

Email: lifting@bickerslifting.co.uk • Web: www.bickerslifting.co.uk