



Grade 80 Bolt-On Lifting Point

Product Specification Sheet

Manufactured to BS EN 1677-1+2

Deutsch BG-Prufzert Type
Approval for Grade 80 Lifting Chain
Components with H91 Certified

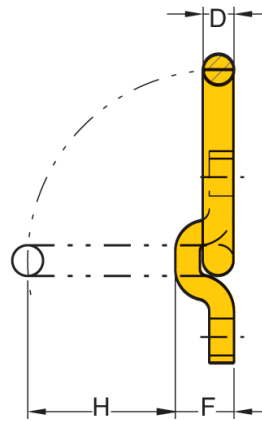
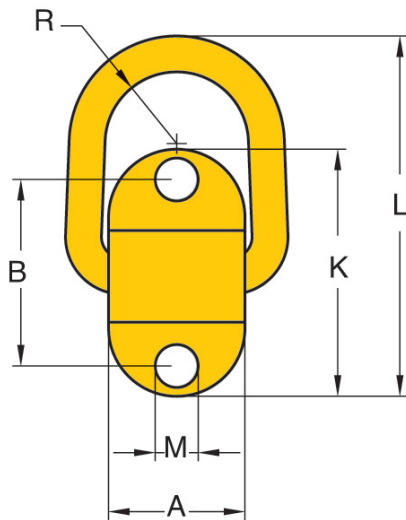

Part Code	W.L.L. tonnes	Dimensions mm									Mass Kg
		A	B	D	F	K	H	M	L	R	
8-058-1T	1.0	50	72	14	27	98	55	14	139	24	0.8
8-058-3T	3.0	58	84	17	33	114	50	16	144	29	1.1
8-058-5T	5.0	64	116	22	43	160	74	20	203	33	2.5